



RA-52

85% Alumina Phos Bond Ceramic Anchor

The RA52 is a premium 85% alumina brick anchor that has exceptional strength, excellent alkali resistance in high temperature applications. Common applications for the RA52 include cement plants, steel re-heat furnaces, aluminum furnaces, power generation and many other demanding applications. The RA52 ceramic anchor is applied in conjunction with the RA57, RA46, RA24 or RA15.

CHEMICAL ANALYSIS (Wt.% - Calcined Basis)

SiO ₂	8.0
Al ₂ O ₃	85.4
TiO ₂	3.1
Fe ₂ O ₃	1.2
CaO	0.2
MgO	0.1
Alkalies	0.3
P ₂ O ₅	1.7

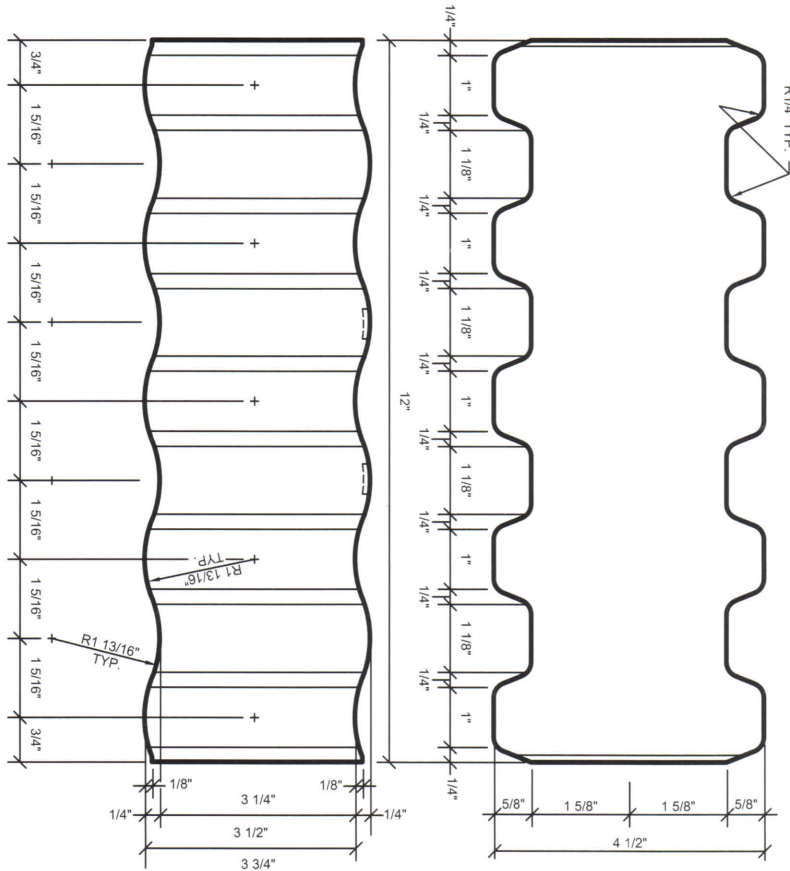

ANCHOR LENGTH

Size	Wt. (lbs. ea.)
6"	8
7	9
8	11
9	12.5
10	14.2
12	17.1
13.5	18.9
14	20.7
15	21
16	22.2
17	30.1

PHYSICAL PROPERTIES

	English Units		SI Units	
	Average	Standard Deviation	Average	Standard Deviation
Bulk Density	117.8	2.5	2,850	40
Apparent Porosity (%)	17.9	1.1		
Tensile Strength* at 68°F (20°C)	Minimum (psi) 2,500		Minimum (MPa) 17.3	

Cold Crushing Strength = 12-15,000 psi

*Force required to fail anchor under tensile load